

EW-T-KF2

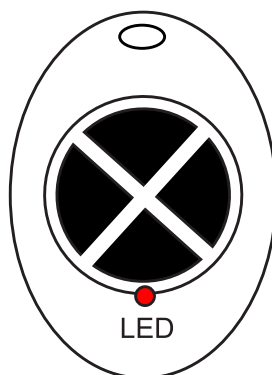

EW-T-KF4

Button operation:

Press = ON/OFF/STOP DIMMING
Hold = DIM UP/DOWN
LED Indicator on button press:
1 Flash = Normal operation
2 Flashes = Battery Low

Battery replacement:

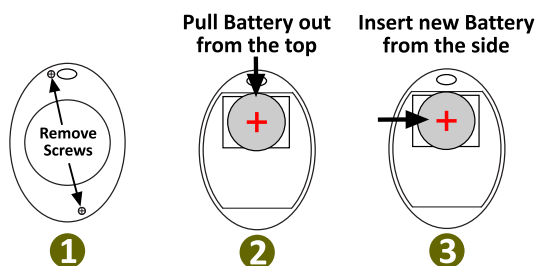

After replacing the battery, the LED will flash 3 times to indicate successful power-up.

Linking to a receiver:

- 1** Connect the receiver to the lights
- 2** Hold the LINK button until the LED starts flashing
- 3** Then press a button on the keyfob within 25sec

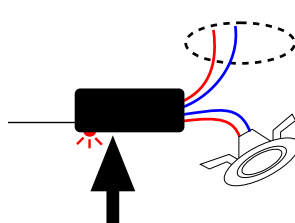
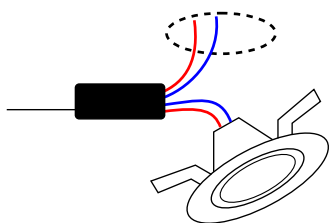

To unlink a button:

Repeat steps 2&3.

To clear all links in a Receiver: Hold the Link Button until the LED is ON solid (10 sec) then release.

A Receiver can link up to 30 different buttons.

Mount the Switch with double sided tape or clip off the outer surround to expose standard 2x4 mounting holes.